

LIGHTERMAN TOWERS

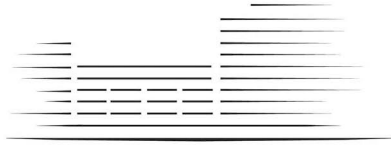

CHELSEA ISLAND

2 BEDROOM APARTMENT

- B.43 Level 4 (55)
- B.53 Level 5 (61)
- B.62 Level 6 (66)

Total Gross Internal Area = 815 sq.ft. / 76 m2

Bedroom = 12' x 11'-1" / 3.6 x 3.4m

Living/Kitchen = 27'-4" x 15'-5" / 8.3 x 4.7m

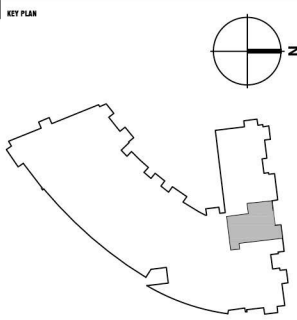

- KEY:
- C Cupboard
 - U Utility Cupboard
 - W Fitted Wardrobe
 - WIW Walk in Wardrobe

THESE DRAWINGS ARE FOR MARKETING PURPOSES ONLY.
FINAL LOCATION AND SET-OUTS TO BE CONFIRMED
DURING CONSTRUCTION PHASE.

FOR INFORMATION ONLY
NOT FOR CONSTRUCTION

Notes:
Measurements are the maximum room dimensions .
Floor layouts are subject to change at any time.
These drawings are for marketing purposes only