

LIGHTERMAN TOWERS



CHELSEA ISLAND

3 BEDROOM APARTMENT

C.14	Level 1	(4)
C.24	Level 2	(10)
C.34	Level 3	(17)
C.43	Level 4	(22)

Total Gross Internal Area = 1424 sq.ft. / 132 m²

Bedroom 1 = 15'-2" x 10'-6" / 4.6 x 3.2m

Bedroom 2 = 17'-2" x 10'-4" / 5.2 x 3.1m

Bedroom 3 = 17'-2" x 9'-6" / 5.2 x 2.9m

Living/Kitchen = 31'-6" x 17'-3" / 9.6 x 5.3m

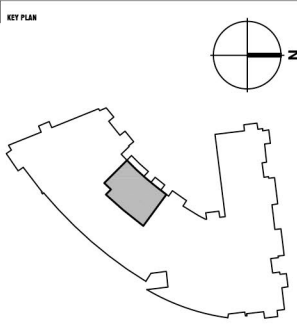

KEY:

- C Cupboard
- U Utility Cupboard
- W Fitted Wardrobe
- W/W Walk in Wardrobe

THESE DRAWINGS ARE FOR MARKETING PURPOSES ONLY.
FINAL LOCATION AND SET-OUTS TO BE CONFIRMED
DURING CONSTRUCTION PHASE.

FOR INFORMATION ONLY
NOT FOR CONSTRUCTION

Notes:

Measurements are the maximum room dimensions .
Floor layouts are subject to change at any time.
These drawings are for marketing purposes only