

LIGHTERMAN TOWERS

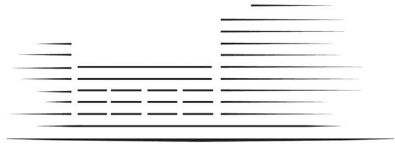

CHELSEA ISLAND

1 BEDROOM APARTMENT

- B.12 Level 1 (33)
- B.22 Level 2 (40)
- B.32 Level 3 (47)
- B.52 Level 5 (60)

Total Gross Internal Area = 819 sq.ft. / 76 m2

Bedroom = 14'-10" x 10'-11" / 4.5 x 3.3m

Living/Kitchen = 30'-8" x 19'-3" / 9.3 x 5.9m

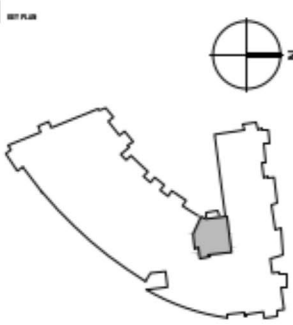

- KEY:
- C Cupboard
 - U Utility Cupboard
 - W Filled Wardrobe
 - WW Walk in Wardrobe

THESE DRAWINGS ARE FOR MARKETING PURPOSES ONLY.
FINAL LOCATION AND SET-OUTS TO BE CONFIRMED
DURING CONSTRUCTION PHASE.

FOR INFORMATION ONLY
NOT FOR CONSTRUCTION

Notes:
Measurements are the maximum room dimensions .
Floor layouts are subject to change at any time.
These drawings are for marketing purposes only